

TRUSTILE[®]
A MARVIN[®] BRAND

TRU&MODERN[®] COLLECTION





EXCEPTIONAL DOORS FOR THE MODERN INTERIOR

Creating a modern home is one of the most exacting architectural styles to achieve. When distilling a home to its simplest form, doors play a critical role in the interior design. We created our Tru&Modern® Collection with this in mind.

From simple to bold, we offer the broadest line of made-to-order, handcrafted, modern doors so you can capture your exact vision.

CONTENTS

Flush Constructed Doors

Flush Doors	3
Flush Doors with Reveals	7
Tru&Modern® Plank (TMP Series)	7
Tru&Modern® (TM Series)	9
Tru&Modern® Infinite Rail (TMIR Series)	11
Tru&Modern® Flush (TMF Series)	13
Flush Doors with Reveals or Metal Inlays	15
Flush Doors with Inset Glass	17
Flush Doors with Reveals and Inset Glass	19

Stile & Rail Constructed Doors

Stile & Rail Construction	21
TruStile MDF Doors	23
TruStile Reserve® Wood Doors	24
TruStile Wood Doors	25
Modern Plank Panel Doors	27
Stacked Rail Doors	29
Modern Panel Doors	33
Modern Adaptations	35
Ultra-Narrow Doors	37
Tiered Mouldings	39
S4S Applied Moulding	41
Senior Flat Panel	43

Materials & Finishes

Wood Species	45
Finish Options	47
Innovative Glass and Resin	48
Metal Panels	50
Metal Inlays	50
Edelman® Leather	51

Hinges & Jambs

Emtek® Square Barrel Hinges	52
Simonswerk® Tectus Concealed Hinges	52
TruStile® Hinges	53
Modern Architectural Door Jambs	54

Wood Entry Systems

Reserve Wood Entry System™	58
Resilient Wood Entry System™	59

Design Tools

TruStile Door Visualizer & Project Configurator	60
---	----



TMF1000 in mahogany with Nutmeg finish and matching flush-to-wall jamb

FLUSH CONSTRUCTED DOORS

Flush Doors

TRU&MODERN® FLUSH (TMF SERIES)

All other flush doors just don't deliver the refinement required for today's modern interior. TruStile flush wood doors feature 1/16" thick hand-selected veneers, precision-matched to optimize the beautiful character found across each species of natural wood.

- Hand-matched 1/16" veneers are available in both horizontal and vertical grain (wood doors only)
- A highly engineered core provides stability for the door, while a matching hardwood edge provides a beautiful finish
- Made to order in sizes up to 4' x 10'
- Available in stain-grade wood or paint-grade MDF

Flush Door Styles

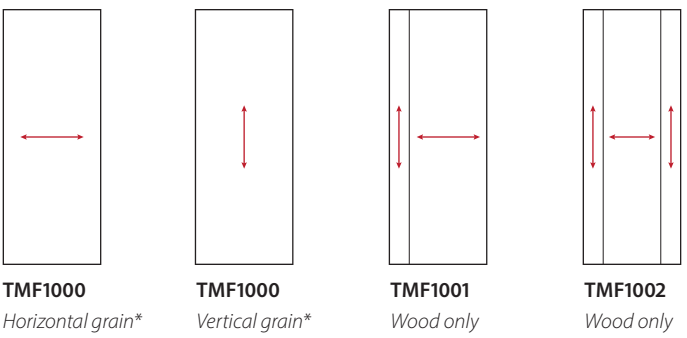

Detailed information on TruStile flush doors is available in our *Flush Door Specification Guide*. Download for free: www.trustile.com/flush-guide

*MDF doors have no grain and are not directional

TruStile Reserve® Wood Flush Doors

- Hand-matched 1/16" veneers are available in both horizontal and vertical grain
- A highly engineered core provides stability for the door while the matching hardwood edge provides a beautiful finish
- Made to order in sizes up to 4' x 10'
- Available in over stain-grade wood or paint-grade MDF

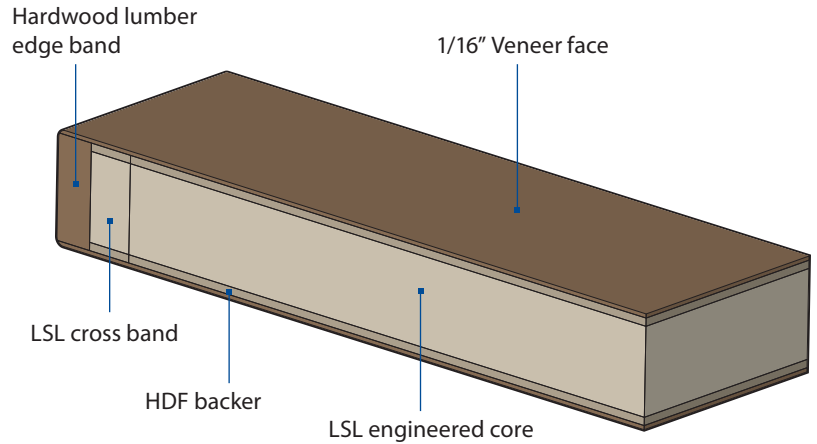

TMF1000 flush door in plain sawn white oak with Grey Mist finish

Hand-Matched Pairs

When hand-matching veneers for pairs, TruStile treats the pattern as though it was covering one extra-wide door. This creates a continuous grain pattern across the width of both doors.

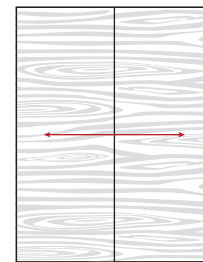

On horizontal pairs, wood grain is continuous across the face of both doors.

Sketch Face Flush Doors

TruStile offers two sketch face door styles that combine hand-matched vertical and horizontal veneers on the same face.

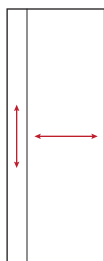

TMF1001
Wood only

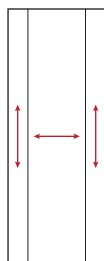

TMF1002
Wood only



TMF1002 sketchface flush door in walnut with clear coat finish



TMF1000 barn door in MDF

MDF Flush Doors

- Highest quality, super-refined MDF creates a smooth paintable surface
- A highly engineered core provides stability for the door while the Wedge Edge®, our patented hardwood edge system, provides a secure mount for hardware
- Made to order in sizes up to 4' × 10'

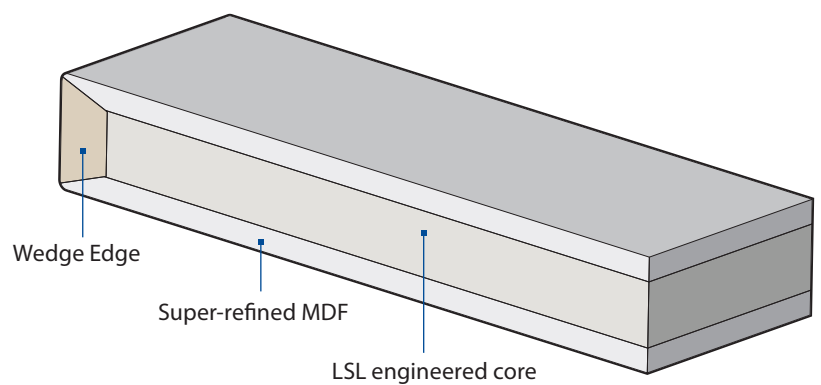



TMP1000 in rift sawn white oak with Honey finish and 1/4" kerf cut reveals

Flush Doors with Reveals

TRU&MODERN® PLANK (TMP SERIES)

Dynamic Plank Doors

Plank count and size are dynamically adjusted to best fit selected door width

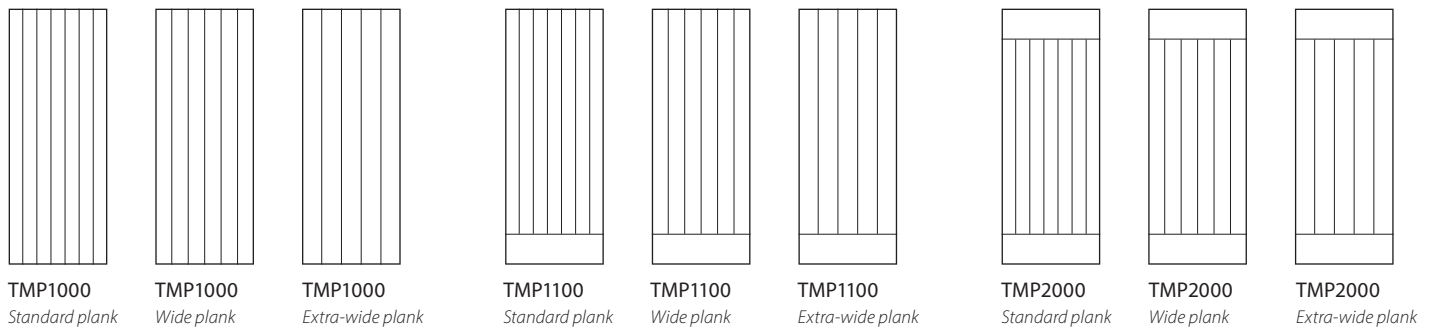

Fixed Plank Doors

Plank count remains fixed across all door widths

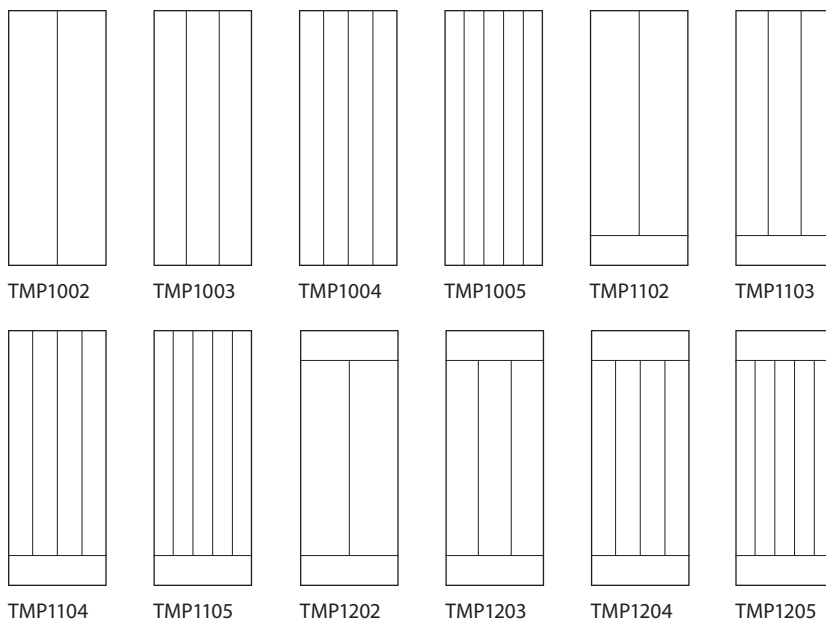

Reveal Options

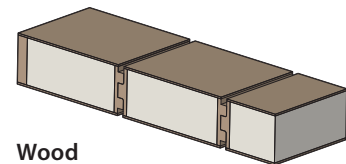

Wood
TMP1000 wood construction
Shown with 1/4" kerf cut

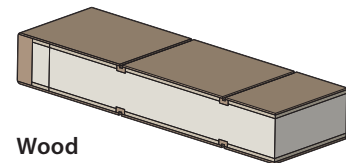

Wood
1/8" Kerf cut reveal

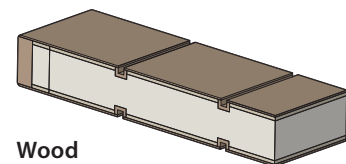

Wood
1/4" Kerf cut reveal

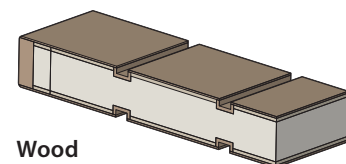

Wood
1/2" Kerf cut reveal

Door styles are available in both MDF and wood. Wood profiles shown right. MDF profiles are shown on page 9.

On some door styles, veneer seams may not align with kerf and may be visible once door is finished.



TM4101 in MDF with 1/4" kerf cut reveals

Flush Doors with Reveals

TRU&MODERN® (TM SERIES)

Reveal details add interest and coordinate with other door styles

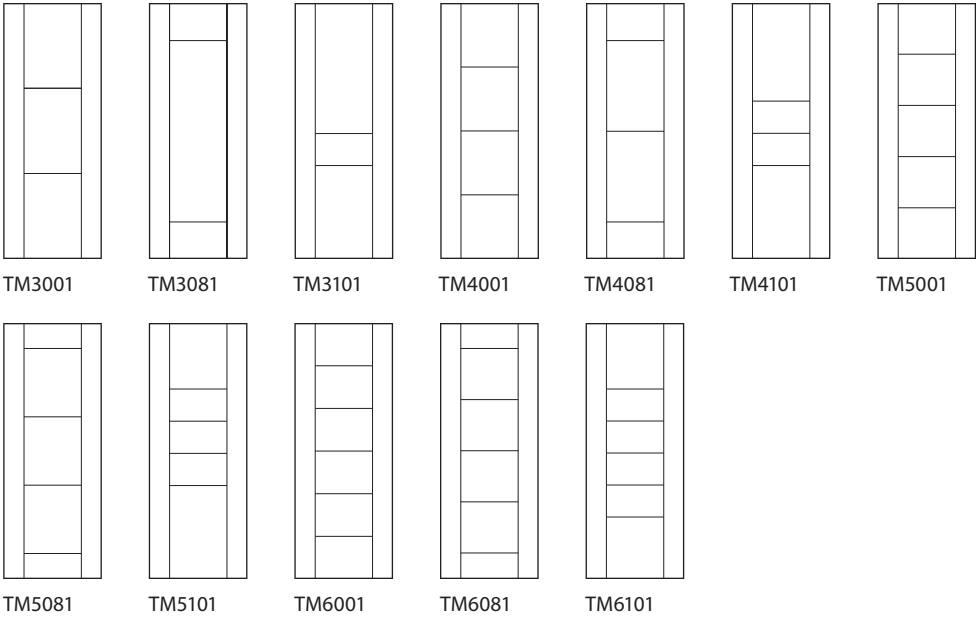

Door styles above are shown with a wide simulated stile configuration. Also available are narrow, ultra-narrow and asymmetrical configurations; which coordinate with modern stile & rail door styles. On wood doors, veneer grain is continuous across the surface; horizontally or vertically depending on your preference.

Reveal Options

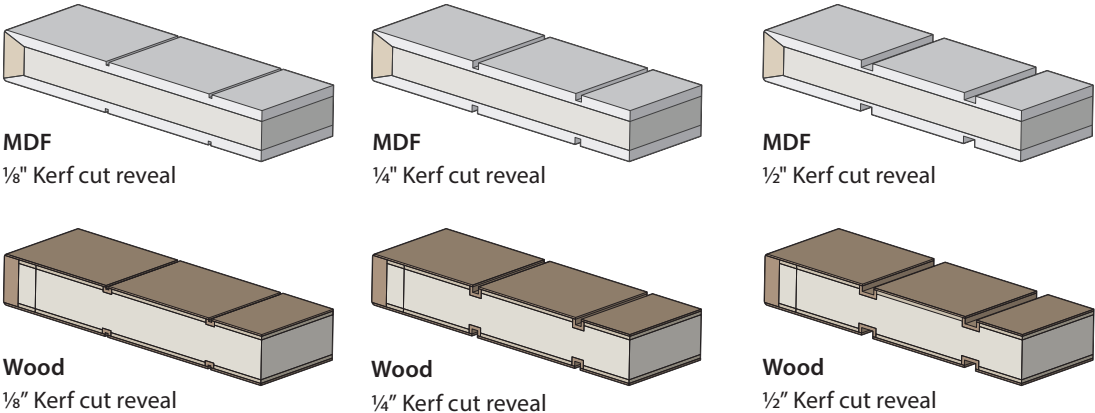



TMIR9001 in plain sawn white oak with Nutmeg finish and 1/4" kerf cut reveal

Flush Doors with Reveals

TRU&MODERN® INFINITE RAIL (TMIR SERIES)

Reveal details add interest and coordinate with other door styles

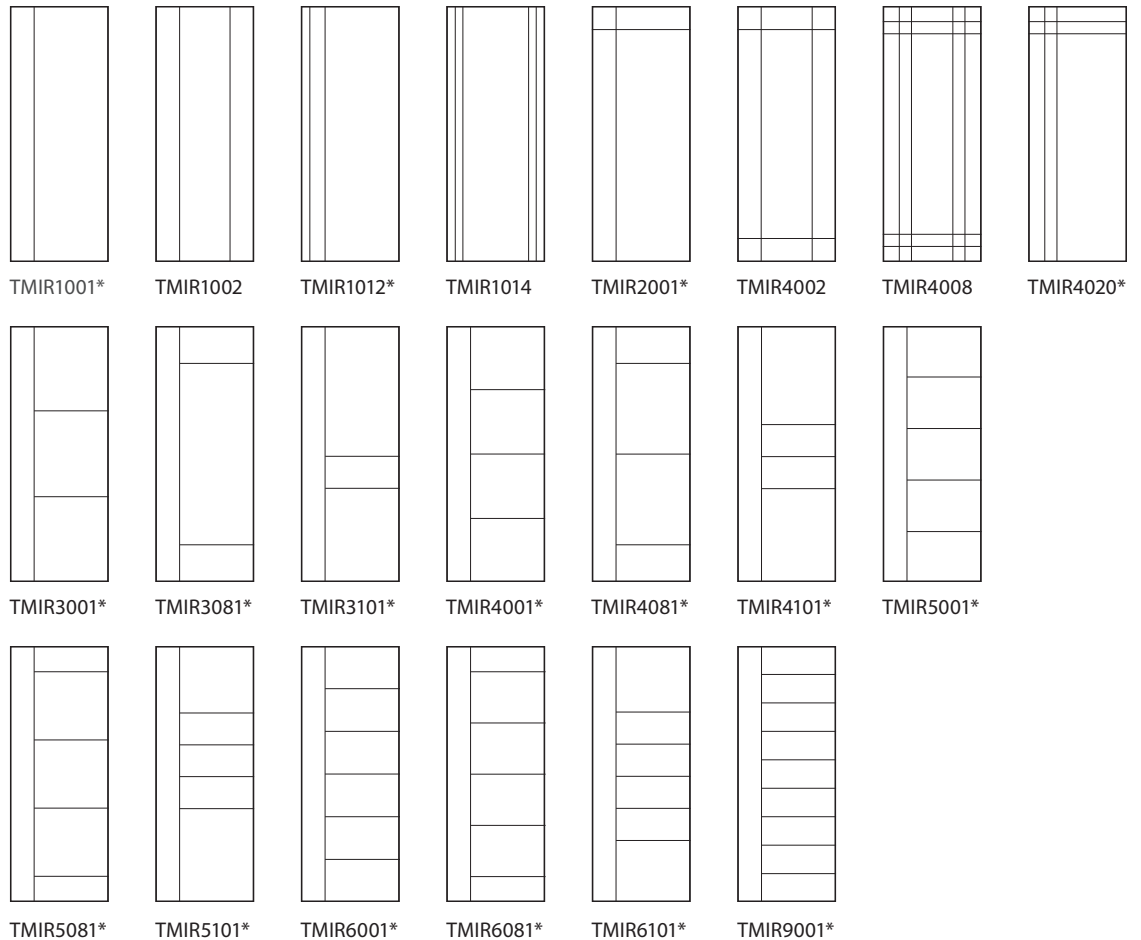

* Handing can be reversed on door style

Reveal Options

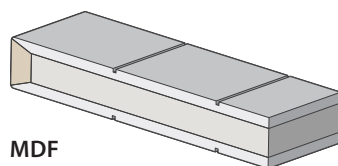

MDF
1/8" Kerf cut reveal

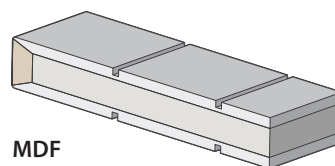

MDF
1/4" Kerf cut reveal

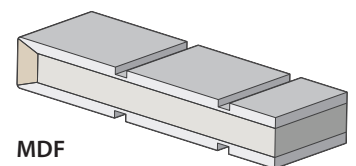

MDF
1/2" Kerf cut reveal

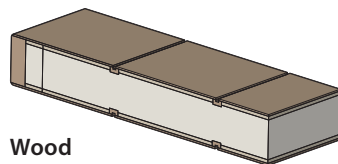

Wood
1/8" Kerf cut reveal

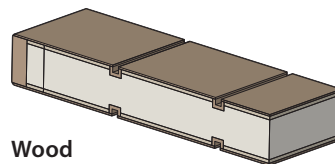

Wood
1/4" Kerf cut reveal

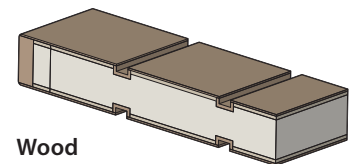

Wood
1/2" Kerf cut reveal



TMF5000 in MDF with 1/4" kerf cut detail

Flush Doors with Reveals

TRU&MODERN® FLUSH (TMF SERIES)

Reveal details add interest and coordinate with other door styles



* Handing can be reversed on door style

Reveal Options

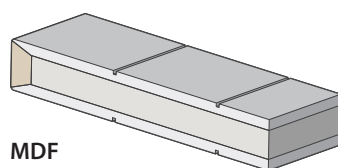

MDF
1/8" Kerf cut reveal

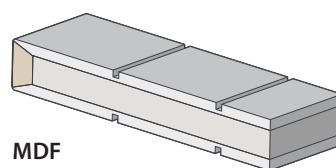

MDF
1/4" Kerf cut reveal

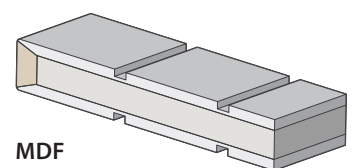

MDF
1/2" Kerf cut reveal

TMIR3200 in MDF with matte
black inlay and flush-to-wall
jamb with 1/2" Z-reveal trim



Flush Doors with Reveals or Metal Inlays

TRU&MODERN® INFINITE RAIL (TMIR SERIES)

Full-width inlays and reveals create a sleek, sophisticated look

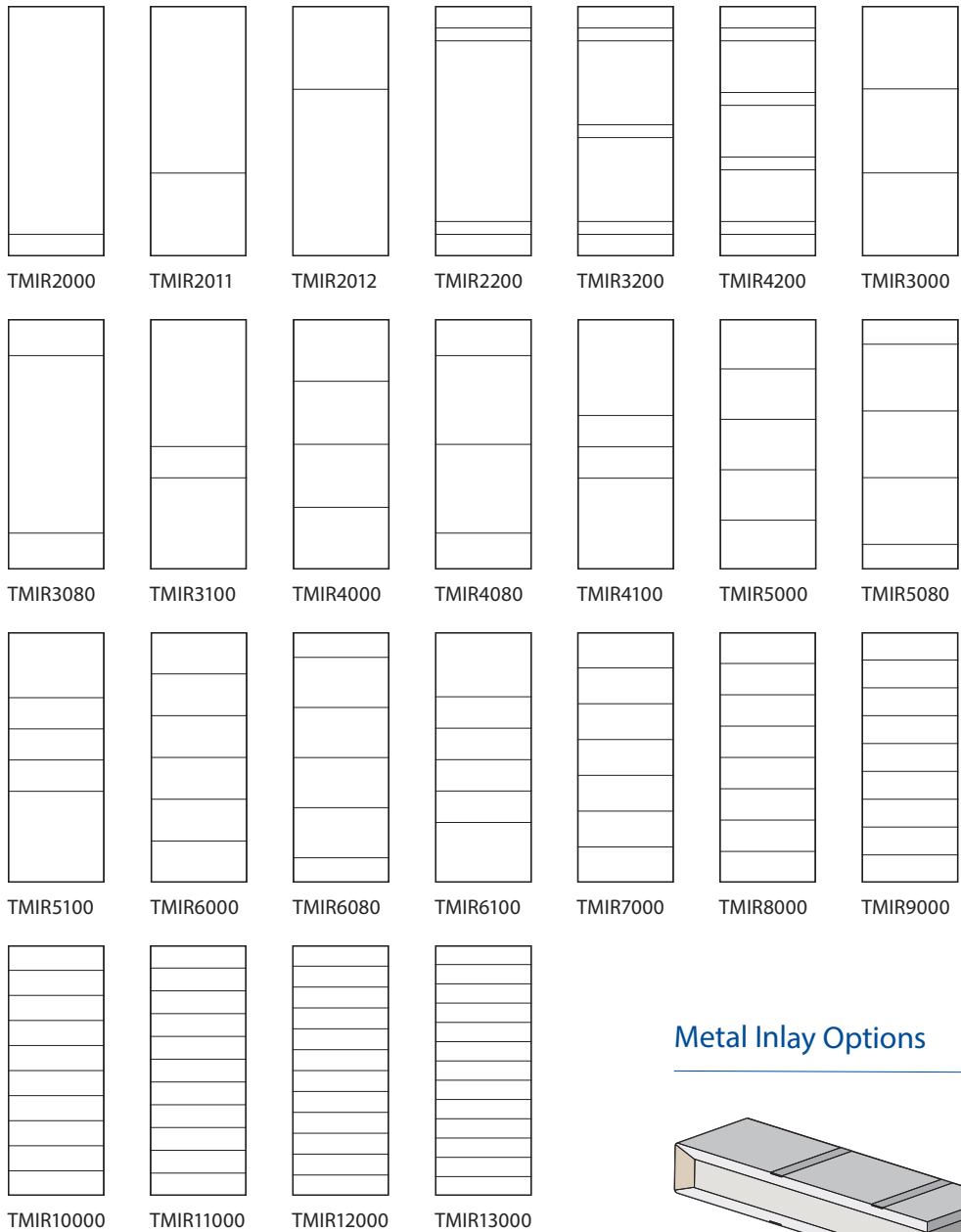

Metal Finish Options



Bright Stainless Steel Finish



Brushed Stainless Steel Finish



Matte Black Finish



Polished Brass Finish



Bright Stainless Steel Finish



Satin Brass Finish

Metal Inlay Options

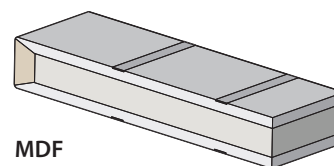

MDF
1/2" Metal inlay

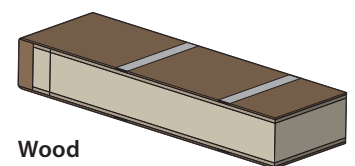

Wood
1/2" Metal inlay

Door styles are available in both MDF and wood; with metal inlays shown above, or any of the kerf cut reveals shown on page 11.

TMFG2012 in mahogany with Slate finish, stopped-in white lami glass and flush-to-wall with jamb reveal



Flush Doors with Inset Glass

TRU&MODERN® FLUSH WITH GLASS (TMFG SERIES)

Creative glass panels bring in light and add interest to modern flush doors

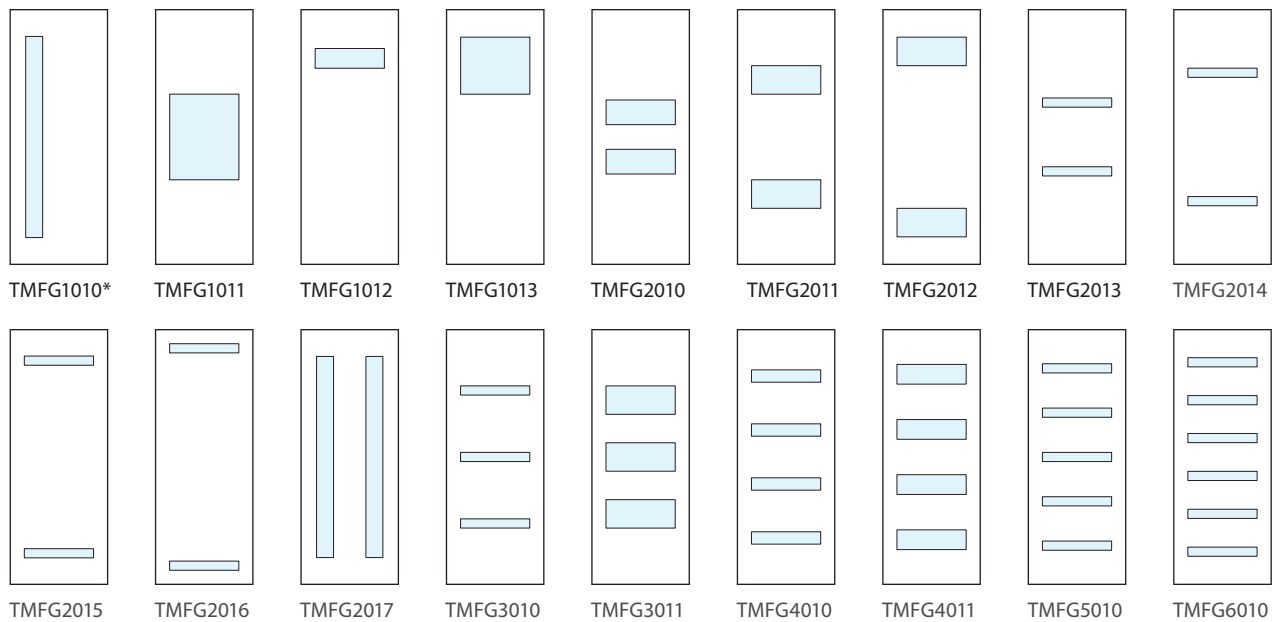

*Handing can be reversed on door style

Profile Detail

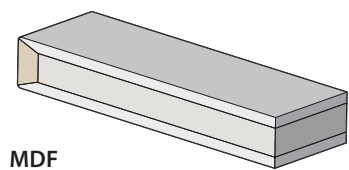

MDF
Flush construction

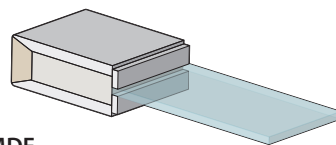

MDF
Stopped-in glass

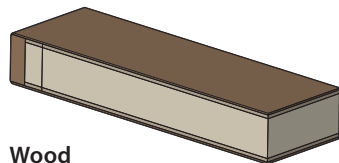

Wood
Flush construction

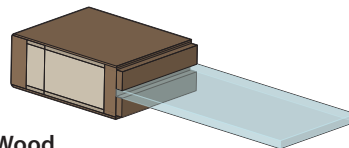

Wood
Stopped-in glass

At just 1/8" deep x 1/4" wide, the stop used to secure the glass in these door styles is nearly flush with the face of the door.



TM1010 in MDF with 1/4" kerf cut reveal, stopped-in white lami glass and projected jamb with inset door and Emtek® square barrel hinges

Flush Doors with Reveals and Inset Glass

TRU&MODERN® (TM SERIES)

Inset glass patterns that integrate with reveal detail

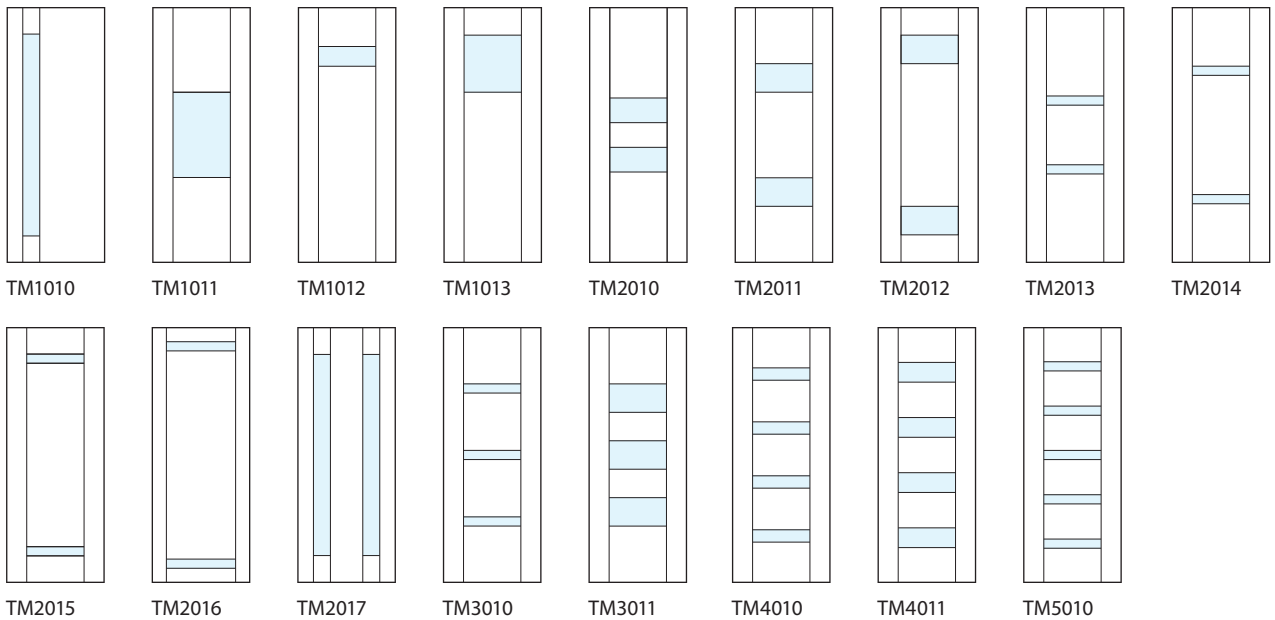

Profile Options

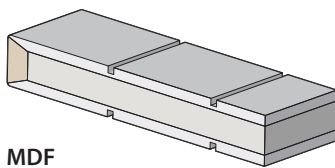

MDF
1/4" Kerf cut reveal

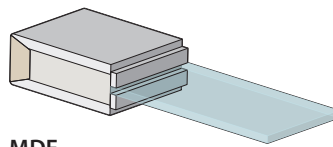

MDF
Stopped-in glass

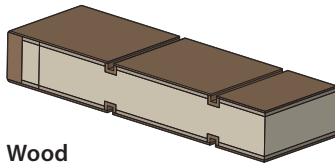

Wood
1/4" Kerf cut reveal

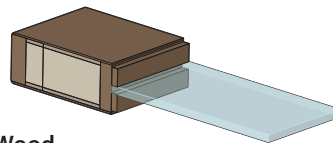

Wood
Stopped-in glass

Glass stop blends with kerf
The stop used for glass is sized to align with the 1/4" kerf cut reveals. The veneer grain runs continuously across the face of the door; horizontally or vertically depending on your preference.



TM6100 in dark-stained white oak with Shagreen Grey Oyster leather, wide stiles and one step (OS) sticking.



STILE & RAIL CONSTRUCTED DOORS

TruStile's authentic stile and rail doors offer crisp details and design flexibility, which can't be replicated in routed or stamped doors. Each door is made to order with perfectly proportioned components, individually crafted to ensure every door is architecturally correct, regardless of size.

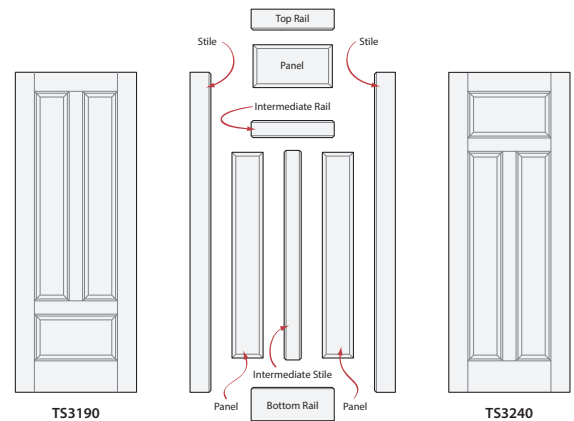

All Doors Are Not Created Equal

The figure illustrates the timeless advantage of TruStile's authentic stile and rail construction. All door components can be customized and combined to create the door style you desire, each with crisp, architecturally-correct details.



TS1000 doors in MDF with Empire (EM) moulding and Flat (C) panel

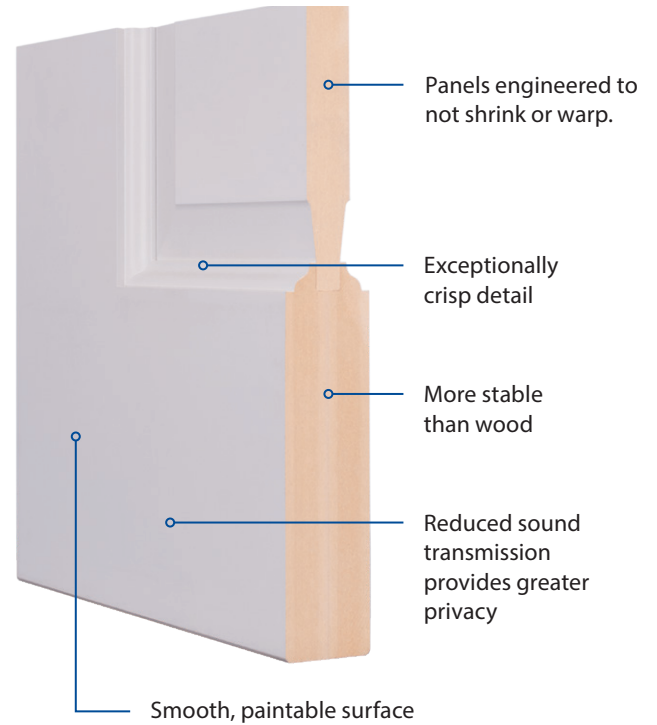

TruStile MDF Doors

TruStile MDF Doors provide quality that is unrivaled. Our use of super-refined MDF and meticulous construction methods result in a painted door product that is a cut above the rest.

- Made to order and built to any size and style.
- Built with genuine stile and rail construction — never routed or stamped with poplar Wedge Edge® provides a secure mount for hardware.
- Made with solid, super-refined MDF that provides a smoother painting surface than pine, poplar or lower-grade MDF alternatives.
- Engineered for maximum stability and durability — won't shrink, expand or warp when exposed to environment.
- More affordable than wood doors.

What is MDF

MDF is an engineered wood product made from compressed wood fibers bound together with resin. The durable and homogeneous construction of MDF resists warping, cracking and splitting and outperforms natural wood doors for painted applications.



TS2020 doors in walnut with clear coat finish, Square Stick (SS) sticking and white lami glass

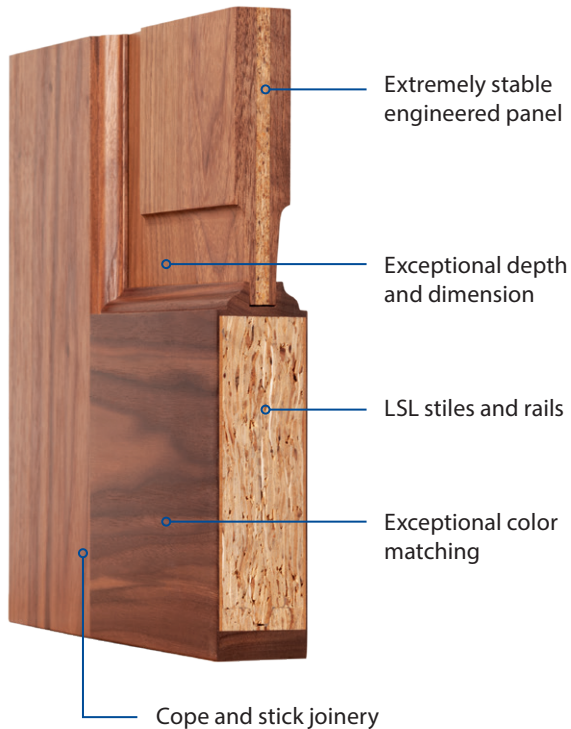

TruStile Reserve® Wood Doors

- Made to order and built to any size and style.
- Incorporates only the finest materials and methods. We have developed a proprietary specification based on the AWI (Architectural Woodwork Institute) standard for AA Premium Grade doors.
- Engineered panels are made with a composite core for strength and stability while maintaining the look of a solid wood panel construction.
- Precision-cut cope and stick joinery provides crisp miter joints.
- The strength and durability of LSL is employed for the ultimate in stiffness to resist bowing, twisting or warping.



TS1000 pocket doors in walnut with Cappuccino finish, Square Stick sticking and Flat (C) panel

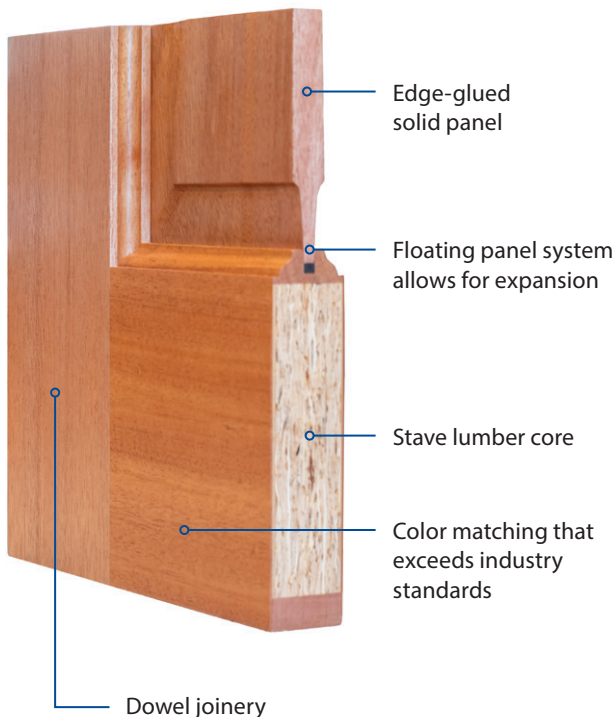

TruStile Wood Doors

- Made to order and built to almost any size or style, using genuine stile and rail construction, industry-leading veneers and quality lumber.
- LSL cores and doweled assembly offers exceptional strength, durability, and maximum stability.
- Solid wood, edge-glued panels. When factory finished, panels are pre-stained on edges prior to assembly.
- A floating panel system uses flexible cushions to secure panels in place — preventing shifting and rattles, while allowing for expansion from environmental changes.
- Cope and stick joinery ensure precise corner detail.
- Meets or exceeds WDMA I.S. 6A industry standards for custom-grade interior doors.



Modern Plank Panel Doors

TRU&MODERN® PLANK (TMP SERIES)

Classic rustic styles with a contemporary twist

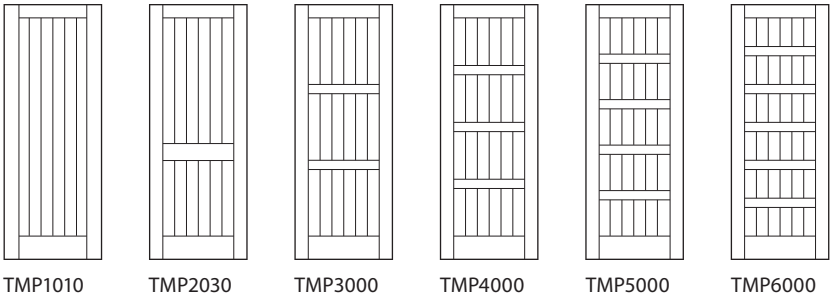

Panel Options

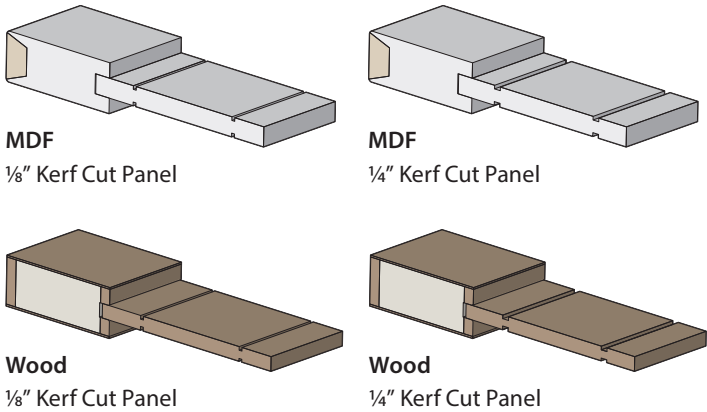

Profiles above shown with Square Stick (SS) sticking. Other standard sticking profiles are also available.

TMP3000 in MDF with Square Stick (SS) sticking, 1/4" kerf cut flat panel and drywall return jamb

TM9430 in walnut with
Nutmeg finish, 1/8" radius
reveals and Flow glass



Stacked Rail Doors

TRU&MODERN® (TM SERIES)

Stacked Rail Door Styles

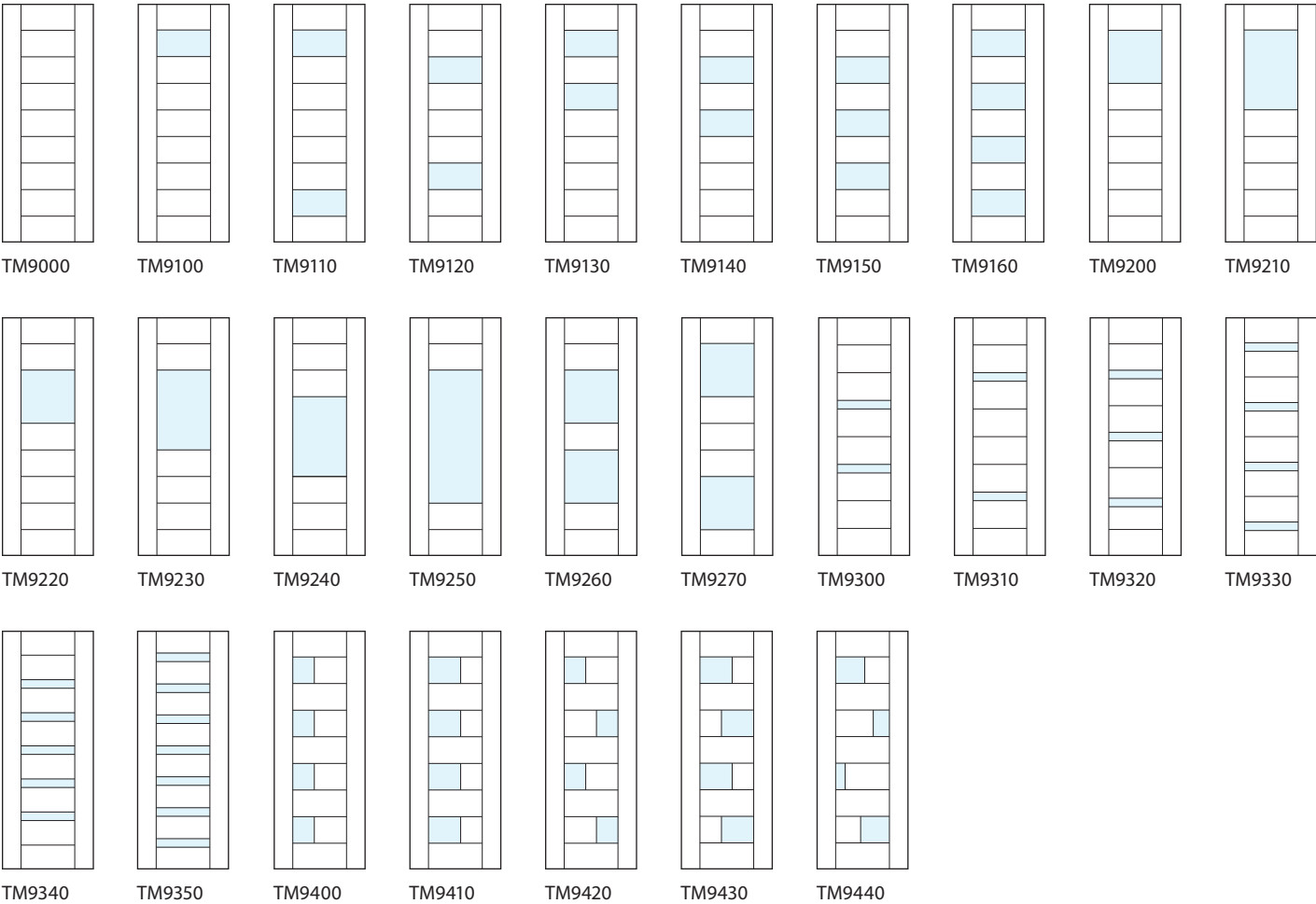

Stile Options

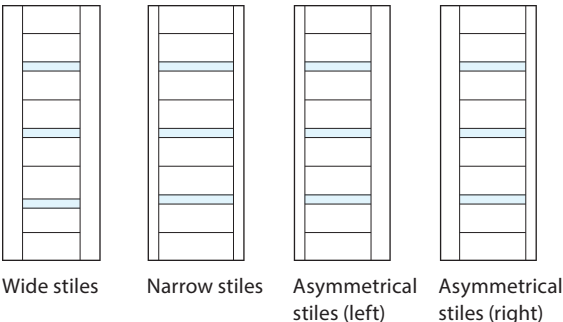

Door styles are shown with wide stile option; narrow and asymmetric stile configurations are also available. Shaded panels indicate an area for an insert selection to be added: leather, metal, glass, resin or a flat MDF or wood panel options are available.

Stacked Rail Doors

TRU&MODERN® (TM SERIES)

Stacked Rail Door Styles

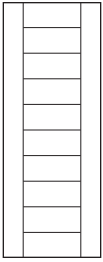

TM10000
10-Rail

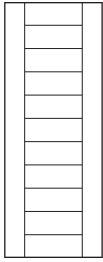

TM11000
11-Rail

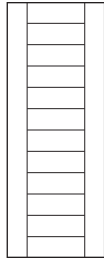

TM12000
12-Rail

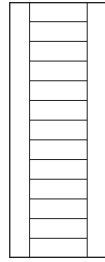

TM13000

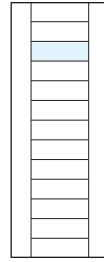

TM13100

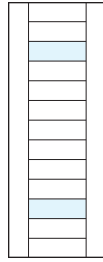

TM13110

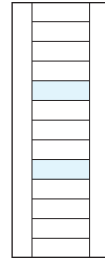

TM13120



TM13130

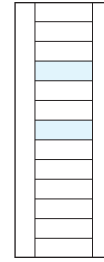

TM13140

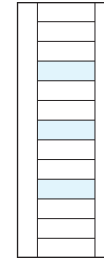

TM13150

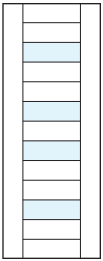

TM13160

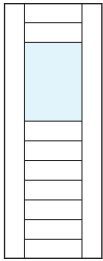

TM13200

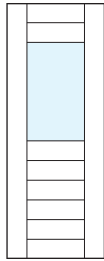

TM13210

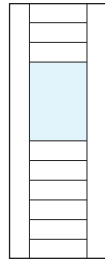

TM13220

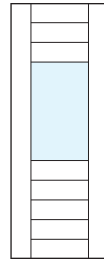

TM13230

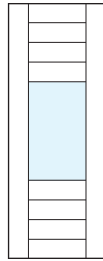

TM13240

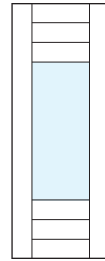

TM13250

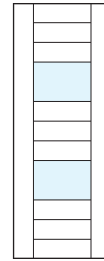

TM13260

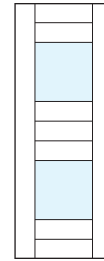

TM13270

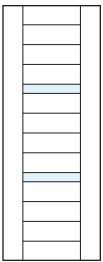

TM13300

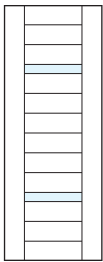

TM13310

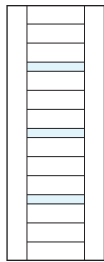

TM13320

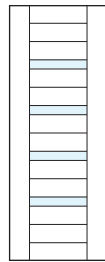

TM13330

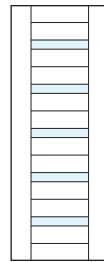

TM13340

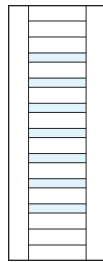

TM13350

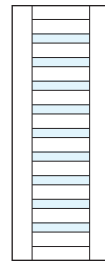

TM13360

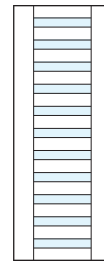

TM13360

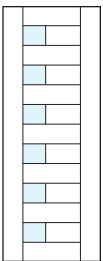

TM13400

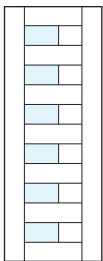

TM13410

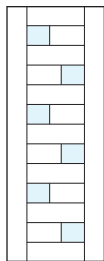

TM13420

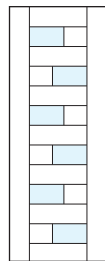

TM13430

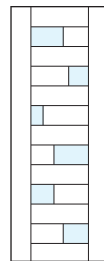

TM13440

Stacked Rail Doors

TRU&MODERN® (TM SERIES)

MDF Profile Options

Wood Profile Options

1/4" KERF CUT REVEAL

1/8" RADIUS REVEAL

1/4" KERF CUT REVEAL

1/8" RADIUS REVEAL

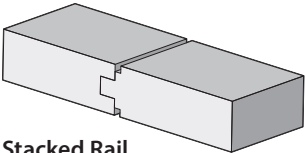

Stacked Rail
1/4" Kerf cut reveal option

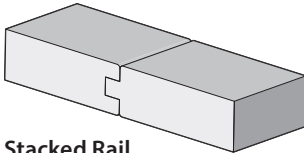

Stacked Rail
1/8" Radius reveal option

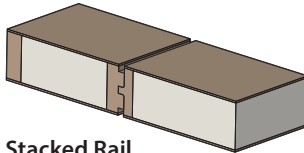

Stacked Rail
1/4" Kerf cut reveal option

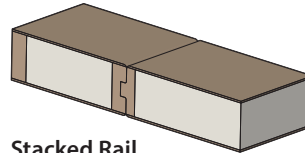

Stacked Rail
1/8" Radius reveal option

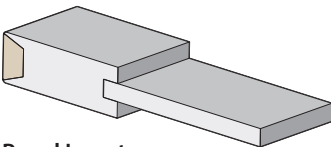

Panel Insert
Compression-fit only

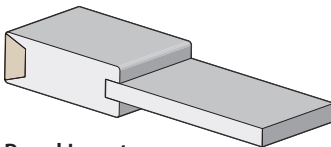

Panel Insert
Compression-fit only

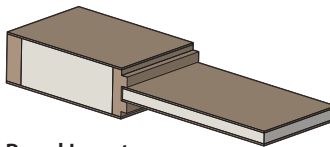

Panel Insert
Compression-fit only

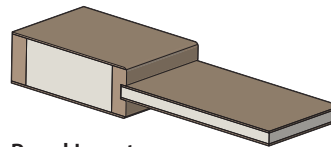

Panel Insert
Compression-fit only

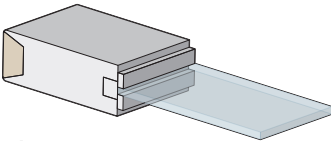

Glass Insert
Stopped-in

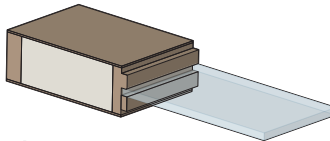

Glass Insert
Stopped-in

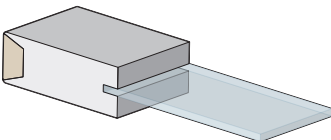

Glass Insert
Compression-fit*

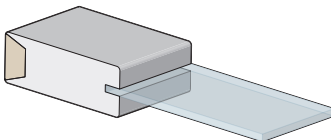

Glass Insert
Compression-fit only*

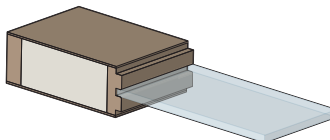

Glass Insert
Compression-fit*

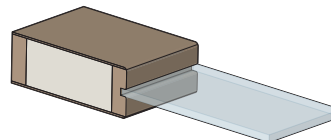

Glass Insert
Compression-fit only*

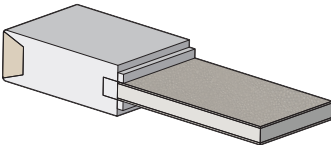

Leather/Metal Insert
Stopped-in only

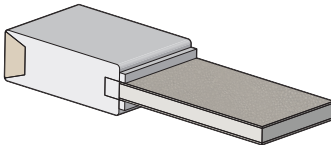

Leather/Metal Insert
Stopped-in only

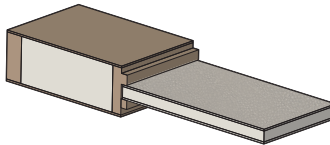

Leather/Metal Insert
Stopped-in only

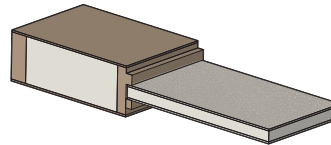

Leather/Metal Insert
Stopped-in only

* Compression-fit glass cannot be replaced if damaged



TM2180 in rift sawn white oak with
Ebony finish and white lami glass



Modern Panel Doors

TRU&MODERN® (TM SERIES)

Stile and rail doors with glass set within double rails

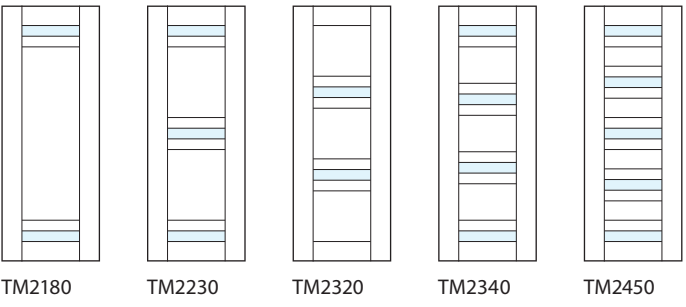

Profile Options

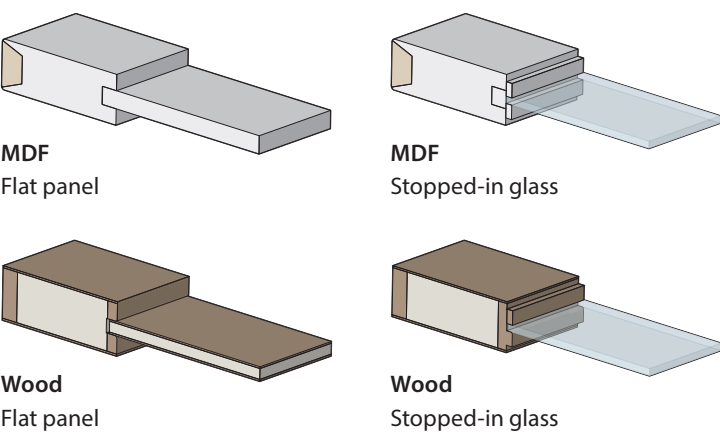



Modern Adaptations

TRU&MODERN® (TM SERIES)

A new look for popular stile and rail door styles

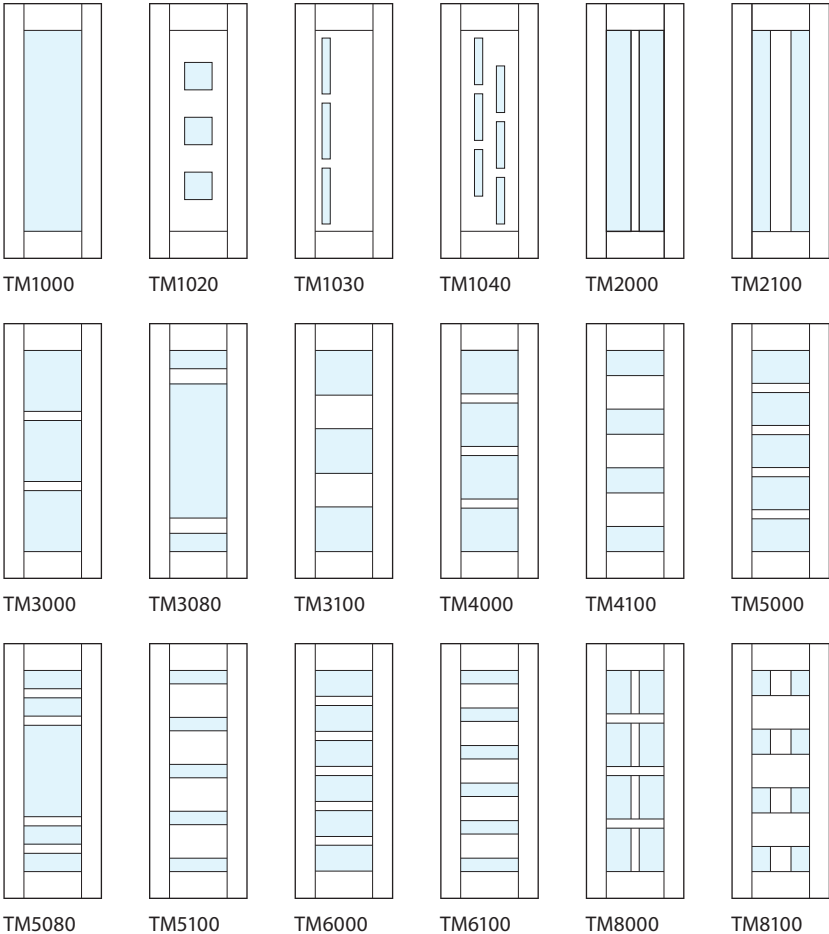

Profile Options

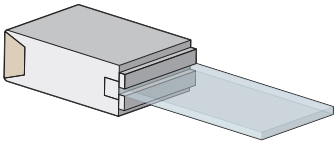

MDF
Stopped-in glass

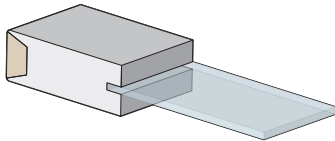

MDF
Compression-fit glass*

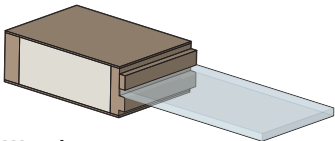

Wood
Stopped-in glass

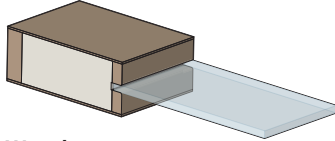

Wood
Compression-fit glass*

* Compression-fit glass cannot be replaced if damaged

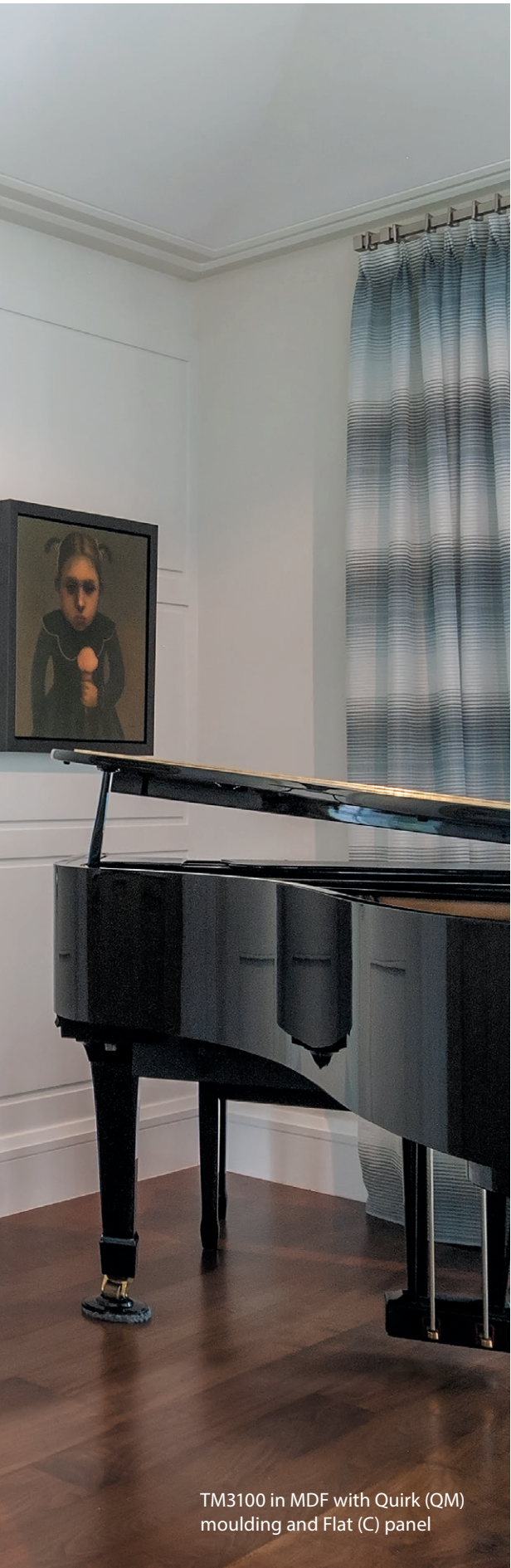

TM3100 in MDF with Quirk (QM) moulding and Flat (C) panel

TMUN5000 sliding doors in quarter
sawn white oak with Grey Mist finish,
Square Stick (SS) sticking and clear glass



Ultra-Narrow Doors

TRU&MODERN® ULTRA NARROW (TMUN SERIES)

Impossibly-thin stiles and rails add an airy feel

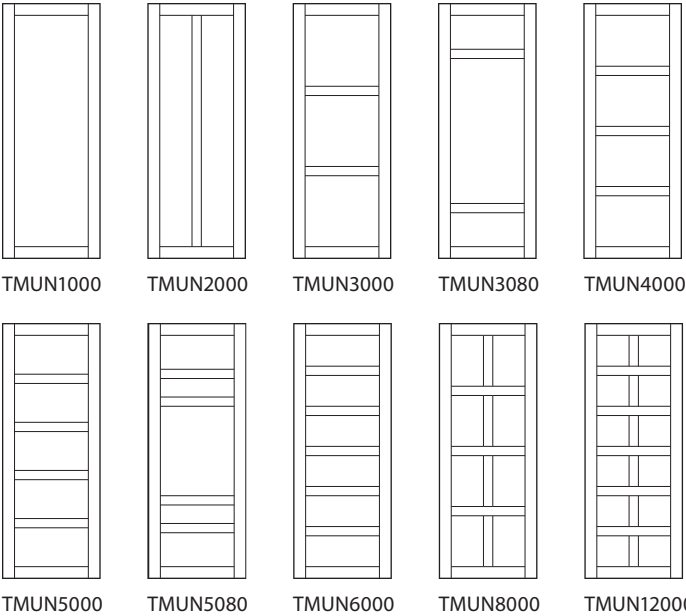

Profile Options

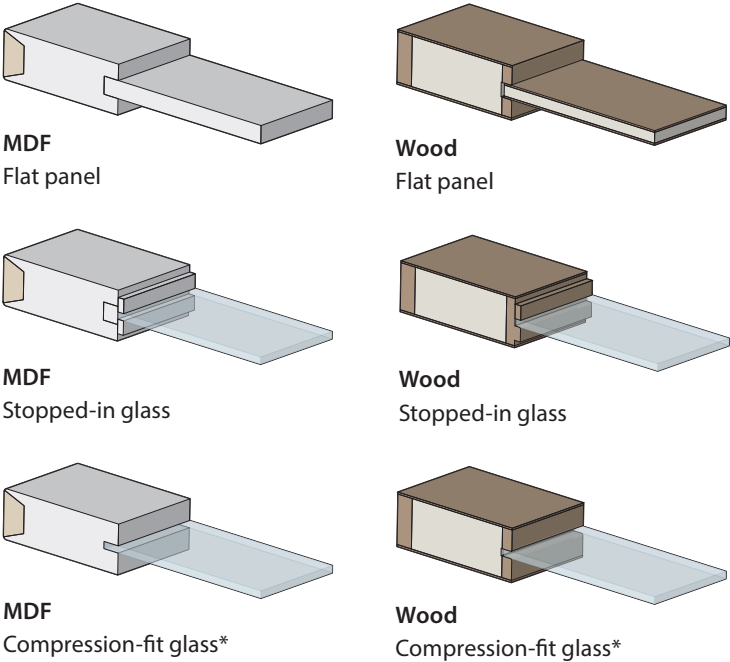

Narrow hardware sets and escutcheon plates recommended with ultra-narrow doors

* Compression-fit glass cannot be replaced if damaged





TS2060 in MDF with Linea (LN) moulding and Flat (C) panel

Tiered Mouldings

MODERN PROFILE OPTIONS

Create a sophisticated look from even the simplest door.

Combine one of our TS Series panel door styles with your choice of applied tiered moulding to add instant impact and contemporary appeal. Tiered mouldings are available for door styles with rectangular panels and look best on styles with fewer panels.

Tiered Moulding Options

MDF CONSTRUCTION

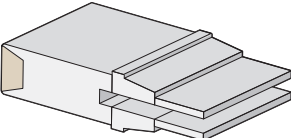

Avant

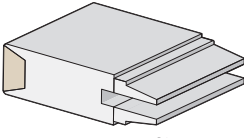

Avant (Low Profile)

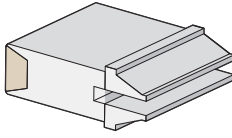

Evoke

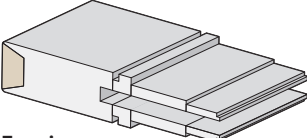

Empire

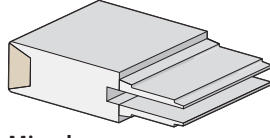

Miracle

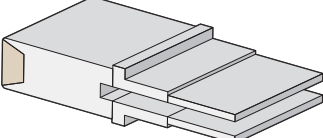

Linea

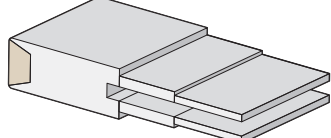

Linea (Low Profile)

WOOD CONSTRUCTION

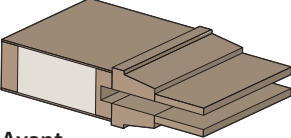

Avant

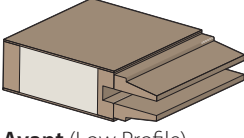

Avant (Low Profile)

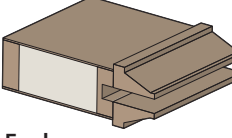

Evoke

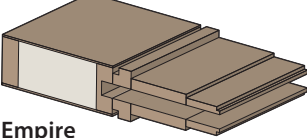

Empire

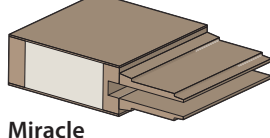

Miracle

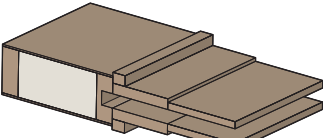

Linea

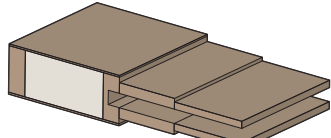

Linea (Low Profile)

TS4100 in MDF S4S two-tiered applied moulding and Flat (C) panel and drywall return jamb



GET THIS LOOK

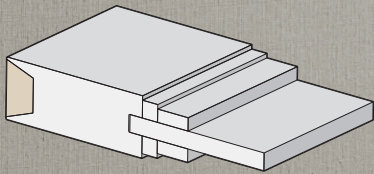

Recreate the look of this S4S applied moulding by selecting two mouldings with the following measurements.

First moulding size $\frac{1}{2}''$ W \times $\frac{1}{2}''$ H

Second moulding size $1''$ W \times $\frac{3}{8}''$ H



S4S Applied Moulding

MODERN PROFILE OPTIONS

Configurable profiles to create a look that is uniquely your own

We are pleased to introduce a configurable "surface 4 sides" (S4S) applied moulding design. Choose one or two tiers of moulding in a variety of customizable dimensions.

Single Tier Examples

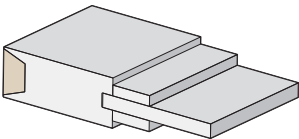

Single tier look
Moulding size 1-1/2" W x 3/8" H

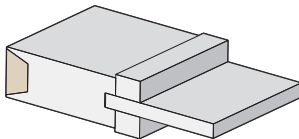

Bold frame look
Moulding size 1" W x 3/4" H

Double Tier Examples

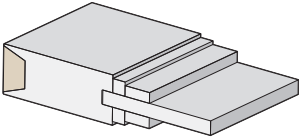

Simple tiered look (shown left)
First moulding size 1/2" W x 1/2" H
Second moulding size 1" W x 3/8" H

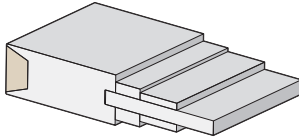

Mid-size tiered look
First moulding size 1" W x 3/8" H
Second moulding size 1-1/2" W x 1/4" H

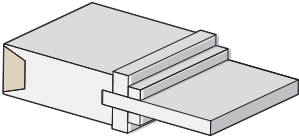

Simple step look
First moulding size 3/4" W x 3/4" H
Second moulding size 1/2" W x 3/8" H

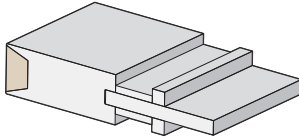

Jumbo quirk look
First moulding size 1-1/2" W x 1/4" H
Second moulding size 1/2" W x 1/2" H

S4S Mouldings is available in both MDF and wood and can be configured with the following dimensions

Width: 1/4", 1/2", 3/4", 1", 1-1/2" **Height:** 1/4", 3/8", 1/2", 5/8", 3/4", 7/8"



TS5000 in rift sawn white oak with Grey Mist finish, Square Stick (SS) sticking, Senior Flat (H) panel and projected jamb and door



Senior Flat Panel

MODERN PROFILE OPTIONS

Available on stile & rail wood doors

Based on a common custom design request, TruStile has developed a new, unique thick flat panel design in wood that provides a modern look with 1/4" gap created between the panel and surrounding stiles and rails. This nearly flush panel option brings a sophisticated, modern look to wood stile and rail doors.

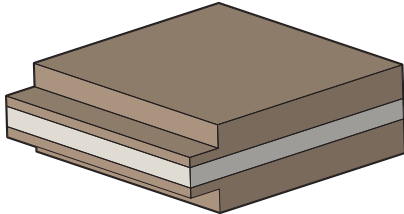

1-3/4" Senior Flat (H) panel
Available in wood only

Available sizes

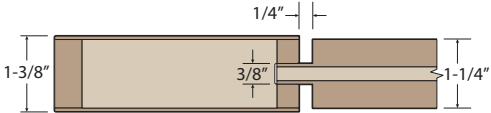

1-3/8" Profile with Square Stick (SS) sticking and Senior Flat (H) panel

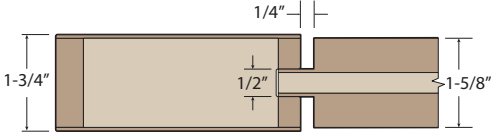

1-3/4" Profile with Square Stick (SS) sticking and Senior Flat (H) panel

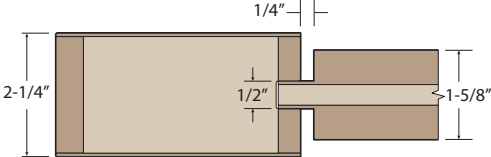

2-1/4" Profile with Square Stick (SS) sticking and Senior Flat (H) panel



TM13000 in cherry with clear coat finish and 1/4" kerf cut reveals

WOOD SPECIES

TruStile offers the broadest selection of wood species on the market. Choose from our standard selections or custom order virtually any species.



Alder, Knotty



Alder, Select



Birch



Cherry



Douglas Fir
Vertical Grain

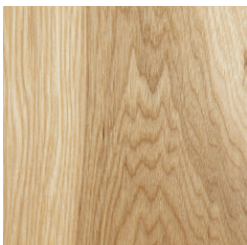

Hickory

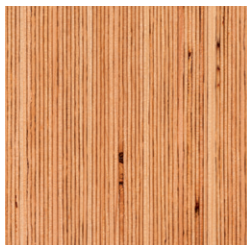

LVL
Laminated Veneer Lumber



Mahogany



Pine
Clear Sugar Pine



Poplar
Stain-Grade & Paint-Grade



Red Oak
Plain Sawn



Walnut



White Maple



White Oak
Plain Sawn



White Oak
Quarter Sawn

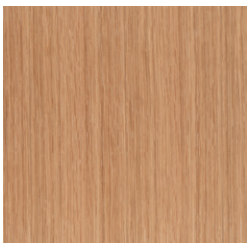

White Oak
Rift Sawn

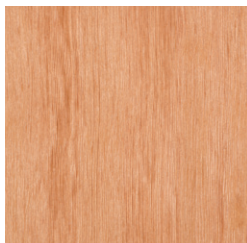

Wire-Brushed Douglas Fir
Vertical Grain

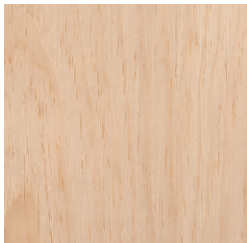

Wire-Brushed Pine
Clear Sugar Pine

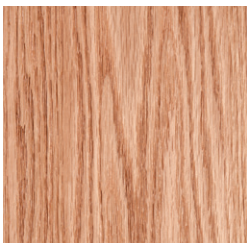

Wire-Brushed Red Oak
Plain Sawn Only

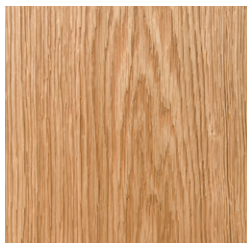

Wire-Brushed White Oak
Plain Sawn Only



Our premium, super-refined MDF provides the smoothest surface for painted applications



TS3000 in mahogany with
Ebony finish, Linea (LN) applied
moulding and Flat (C) panel

FINISH OPTIONS

Interior wood doors are all available with a premium hand-wiped finish that accentuates the natural beauty of our doors. Edges of all panels are finished before being inserted into our doors, ensuring unfinished wood is not exposed with environmental changes. Visit www.trustile.com/finishes to see detailed finish sample images.

	Alder*	Birch	Cherry	Clear Pine	Douglas Fir	Hickory	Mahogany	Poplar	Red Oak*	Walnut	White Maple	White Oak*
Amaretto												
Bleached												
Cameo												
Cappuccino												
Caramel												
Champagne												
Cinnamon												
Ebony												
Espresso												
Grey Mist												
Hazelnut												
Honey												
Nutmeg												
Slate												
White Haze												

* White oak is available in plain sawn, rift sawn and quarter sawn cuts. Alder available in select alder or knotty alder.

INNOVATIVE GLASS AND RESIN

Replace most any panel with the latest trends in architectural glass from Bendheim® or designer resin from 3Form®

Glass & Mirror Options



Clear



Bevel

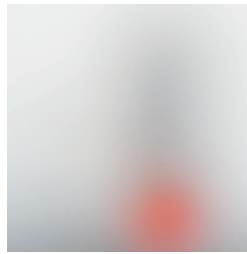

Frosted

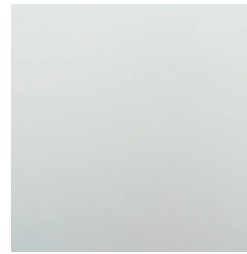

White Lami



Arctic

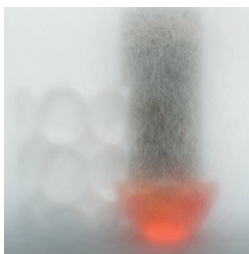

Brushed



Clear Leaf

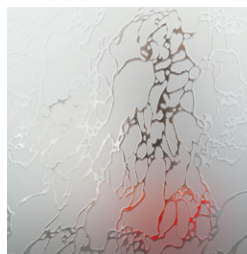

Delta Frost

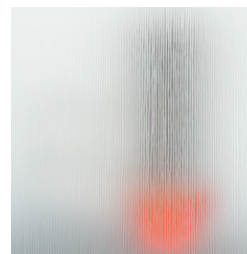

Flow

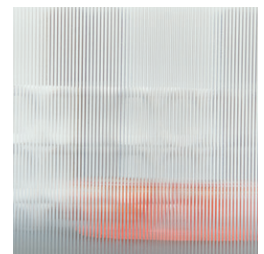

Groove

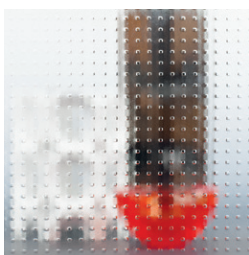

Master Carre



Obscure

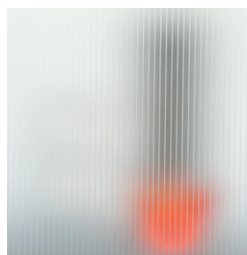

Pinstripe

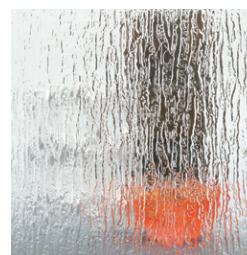

Rain



Reeded



Satin Barcode



Seedy Wash



Shoji



Spun



Tuxedo



Wave



Whirl



Bronze Fibers Mirror

3form® Resin Options

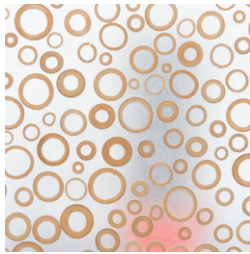

Bamboo Rings

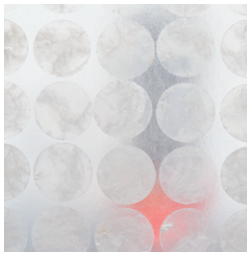

Capiz

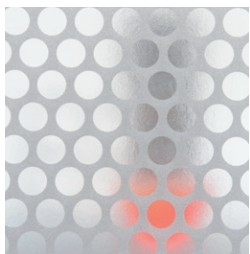

Cirque

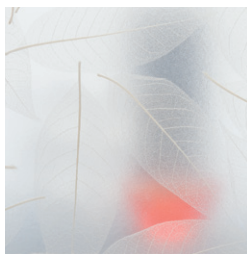

Fossil

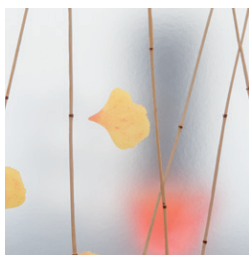

Ginkgo Thatch

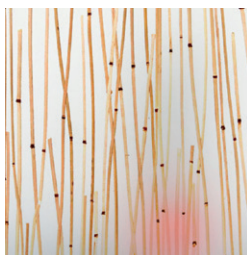

Thatch

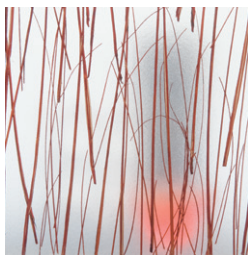

Ting Ting



TM9430 in walnut with Nutmeg finish, 1/8" radius reveal and Flow glass inserts

Visit www.bendheim.com and www.3-form.com for hundreds of custom glass and resin options.

METAL PANELS

High-quality wood and imaginative finishes combine for an entirely new perspective on what a modern interior can be. Substitute almost any panel for a decorative metal insert from architectural supplier Chemetal®.



Brushed Aluminum



Brushed Brass



Brushed Bronze

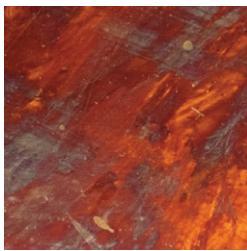

Patina Aurora



Patina Canterbury



Patina Monet

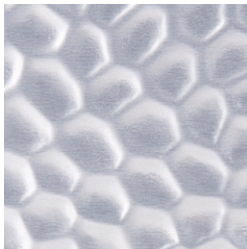

Hammered Argenta

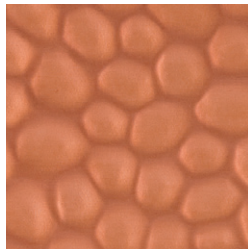

Cobble Stone
Limited availability

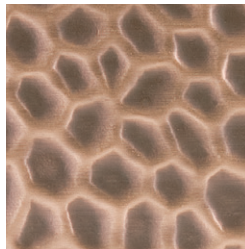

Reptilian
Limited availability



METAL INLAYS

Metal Inlays are available on our Infinite Rail (TMIR series) interior door styles with horizontal kerfs, shown on page 15.



Bright Stainless Steel



Polished Brass



Satin Black

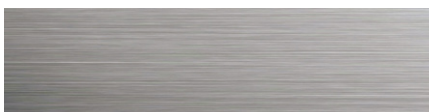

Brushed Stainless Steel



Brushed Light Brass



Satin Copper

EDELMAN® LEATHER

Substitute almost any panel with the finest Edelman leather. Select either a laminated or upholstered appearance for your leather panels.

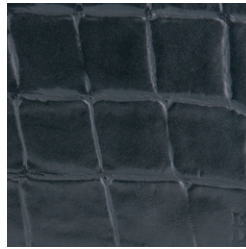

Croc Black

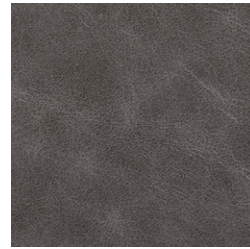

Dashing Old Sterling



Shagreen Café Latte

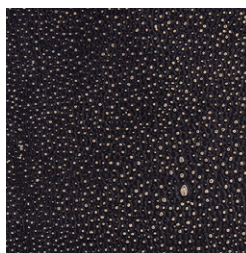

Shagreen Caviar



Shagreen Couscous

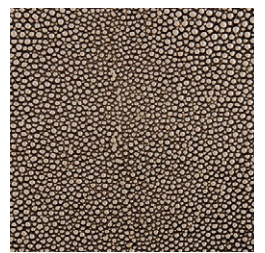

Shagreen Grey Oyster



Sulky Grey Mare



Oak



Pampas

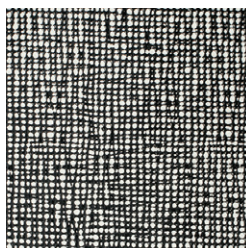

Wagon Lit Milk & Cookies

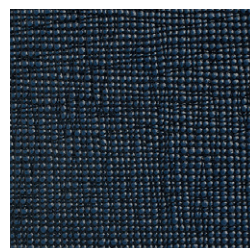

Wagon Lit Newest Navy

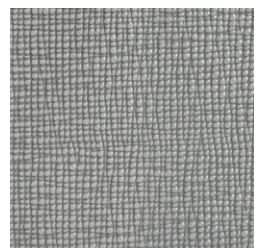

Wagon Lit Sonic

Opposite page: TS3000 with Roman Ogee (OG) sticking and Patina Monet panel

Above: TM9340 in walnut with Nutmeg finish, ¼" kerf cut reveals and Shagreen Café Latte leather

HINGES



Shown in Satin Nickel

Simonswerk®

TECTUS CONCEALED HINGES

Simonswerk Tectus concealed hinges offer a sleek, clean look perfect for today's modern interiors. These precision hinges are fully adjustable in three dimensions, making it simple to create a perfect margin between the door and frame.

Our concealed hinge offering is available on any of our 1-³/₄" or 2-¹/₄" thick doors and provides a complete solution: precision-machined door, fully prepped ready-to-assemble jamb and choice of Tectus hinges. Not available on pre-hung units.

Emtek®

SQUARE BARREL HINGES

Emtek square barrel hinges offer a unique, modern rectangular spine profile when the door is closed. With smooth action, a solid brass construction and loads of style, these hinges offer a sophisticated look and feel.

The hinge barrel also features no exposed screws for an aesthetically clean look, unlike some other options on the market.

Emtek square barrel hinges are available in 3-¹/₂" × 3-¹/₂", 4" × 4" and 4-¹/₂" × 4-¹/₂" sizes and are available in a wide variety of finishes.



Shown in US4 Satin Brass finish



Shown in US10B Oil-Rubbed Bronze finish

TruStile® Hinges

HEAVY DUTY BALL-BEARING HINGES

TruStile offers architectural-grade, square corner, ball bearing hinges custom built to its specifications.

Doors that are ordered pre-hung receive 4" hinges on 1-3/4" doors, while 1-3/8" doors receive 3-1/2" hinges.

4-1/2" hinges are available for 1-3/4" and 2-1/4" doors. Hinges can also be ordered for TruStile doors not pre-hung at the factory.

Available Hinge Finishes



US3 Bright Brass



US4 Satin Brass



US5 Antique Brass



US10A Antique Bronze



US10B Oil-Rubbed Bronze



US14 Polished Nickel



US15 Satin Nickel



US15A Antique Nickel



US19 Flat Black



US26 Polished Chrome



US26D Satin Chrome

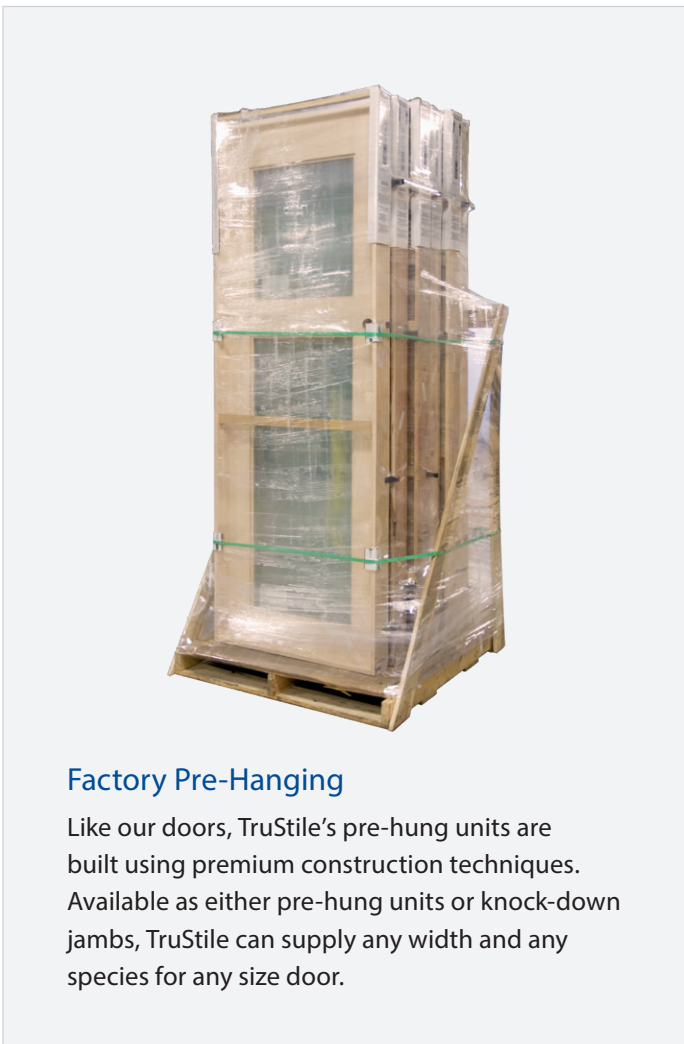

Factory Pre-Hanging

Like our doors, TruStile's pre-hung units are built using premium construction techniques. Available as either pre-hung units or knock-down jambs, TruStile can supply any width and any species for any size door.

JAMBS

Modern Architectural Door Jambs

FOR TODAY'S DRYWALL TREATMENTS

The new TruStile modern casing-less door jamb configurations bring high-end, configurable designs that complete the look of modern openings in your projects. Discerning building professionals and their clients will appreciate the innovative options that create seamless lines and eliminate the need for casing around each door throughout the home.



The complete TruStile jamb offering is detailed in our *Interior Residential Jambs & Accessories Specification Guide*. Download for free at: www.trustile.com/jamb-guide



Projected Jamb with Inset Door

Exposed jamb edge projects from wall with inset door that is flush to wall

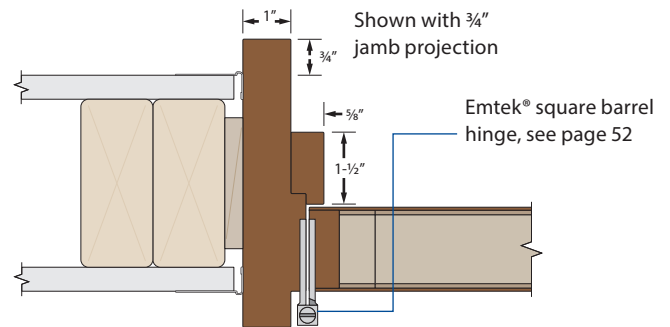

Jamb detail with L-bead trim and barrel hinge

Emtek square barrel hinges look great with this modern door and jamb, but most standard barrel hinges will work too.



Flush-to-Wall Jamb

Exposed jamb edge with door and jamb flush to wall

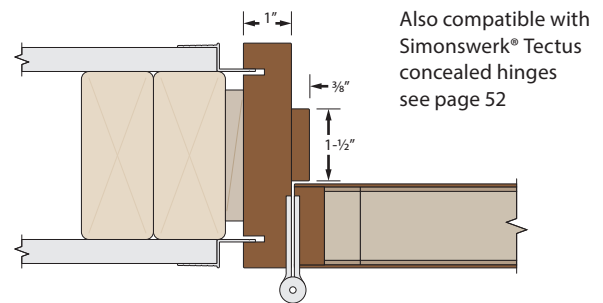

Jamb detail with Z-reveal trim and barrel hinge

Backside kerf requires minimum 1" thickness. Also available in single rabbet configuration.



Projected Jamb and Door

Exposed jamb edge projects from wall with door that sits flush to edge of jamb



Drywall Return Jamb

Semi-concealed jamb edge with door and jamb recessed in wall

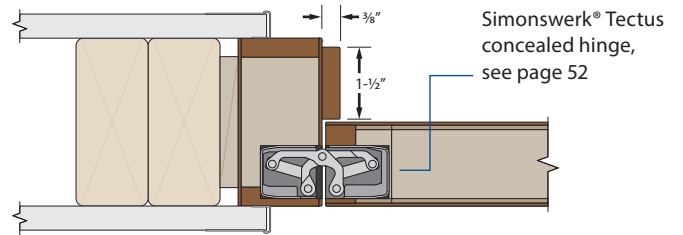
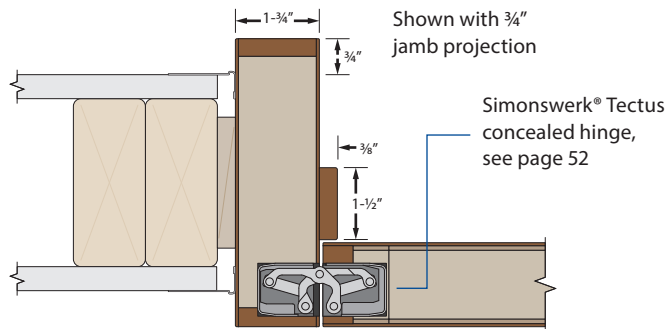

Jamb detail with L-reveal trim and concealed hinge
Compatible with standard barrel hinges.

Jamb detail of drywall return jamb with concealed hinge
Compatible with standard barrel hinges. Jamb must be installed before applying drywall



Flush-to-Wall Jamb with Reveal

Exposed jamb edge with built-in reveal, door and jamb flush to wall

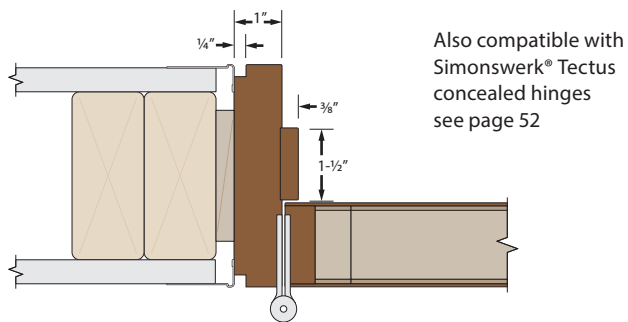

Jamb detail with L-bead trim and barrel hinge
Also available in single rabbet configuration.



TMIR6000-106B in Mahogany with
Nutmeg finish and ¼" kerf cut reveals



WOOD ENTRY SYSTEMS

Make the entry to your home a most welcoming invitation with an exceptional entrance by TruStile. In collaboration with our parent company, Marvin®, we have engineered a family of premium entry systems that don't just transform a space, but how you feel inside it.

With the Reserve Wood Entry System™ and Resilient Wood Entry Systems™ you have two options that take exterior doors to the next level. The Resilient Wood Entry System sets the tone of quality for the whole home using the most durable paint-grade construction without sacrificing any design options. The Reserve Wood Entry System elevates the refined elegance of your home with the beauty of stained natural wood.

Both entry system solutions have been extensively tested and proven in partnership with the Marvin® Research and Development team.

MARVIN® 



For more information about our wood entry systems, to request your copy of our entry systems catalog,

www.trustile.com/entry



TruStile entry systems are solely available for residential applications.



TMIR1002-102B in walnut with Ebony finish and 1/4" kerf cut reveals

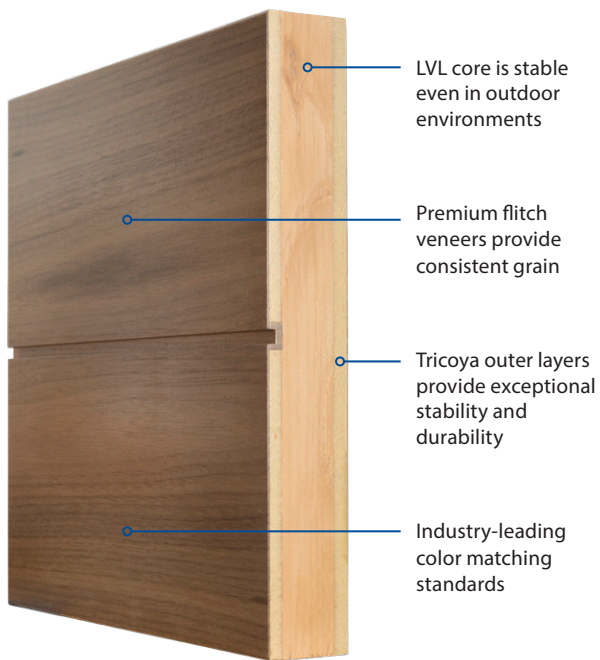

Reserve Wood Entry System™

The Reserve Wood Entry System elevates the refined elegance of your home with the beauty of stained natural wood.

- Engineered with a laminated veneer lumber (LVL) core and Tricoya® layers to provide exceptional stability and durability.
- 10 natural wood species available with an extensive collection of premium factory stain options.
- Premium appearance standards ensure industry-leading grain and color matching.
- 5-year limited warranty with industry standard overhang requirements for both inswing and outswing units.



TMIR4000-108A in Resilient engineered wood with 1/4" Kerf cut reveals

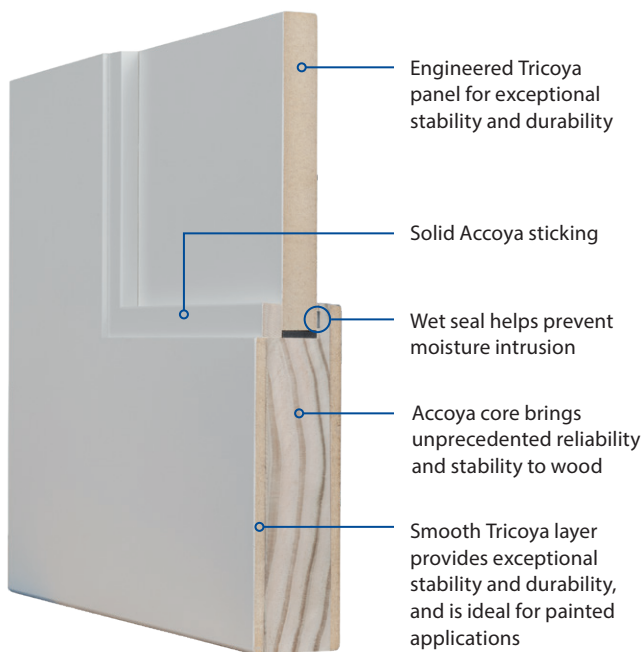

Resilient Wood Entry System™

The Resilient Wood Entry System sets the tone of quality for the whole home using the most durable painted construction without sacrificing any design options.

- Engineered with resilient Accoya®, an acetylated wood product, which brings unprecedented reliability and durability to wood.
- Tricoya® top layers provide exceptional stability, durability and paintability, for outdoor applications.
- Most configurations delivered pre-hung with an Accoya built jamb and a premium prime finish, ready to paint to match your design.
- 10-year warranty with limited and no-overhang applications, depending on system design specifications, for both inswing and outswing units.

DESIGN TOOLS

Design, Configure and Visualize Your Projects

Door Visualizer

Imagine the possibilities for your home with the TruStile Door Visualizer. Customize your door's style and materials and see changes in real-time.

Share a link to your configured door with others or download a PDF tear sheet, high resolution image or 3D model for use in modeling programs.



www.trustile.com/visualizer

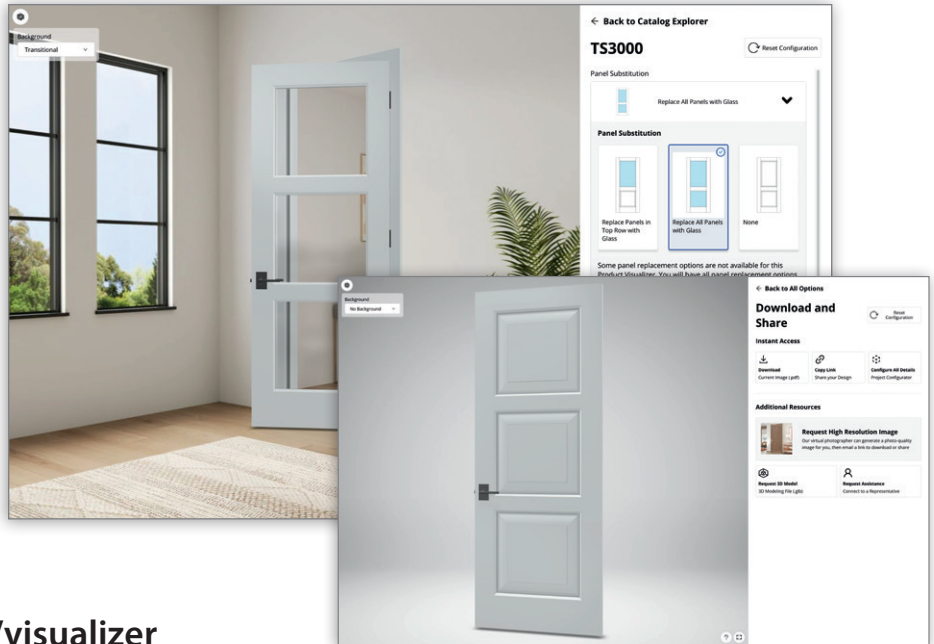

Project Configurator

Design your own door package. Specify the height, width and location of all components within a door and save to a project.

Project Configurator projects can be exported as a door schedule that opens directly in Microsoft® Excel, as a PDF of drawings or CAD models to import directly into your plans.



www.trustile.com/configurator

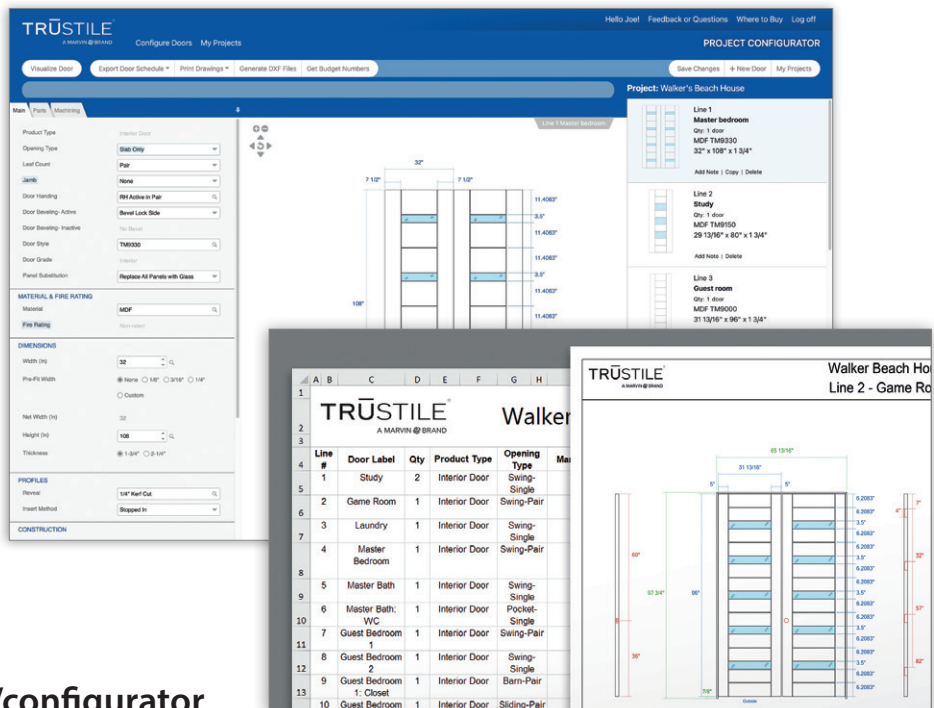



TMUN3000 in MDF with Square Stick (SS) sticking and clear glass



Back Cover: TM9440 in MDF with 1/8" radius reveal and Patina Monet metal inserts

Front Cover: TM9330 in walnut with clear coat finish, 1/4" kerf cut reveal and Sulky Grey Mare leather

TRUSTILE[®]
A MARVIN  BRAND



FOLLOW US



www.trustile.com

TRUSTILE DOORS, LLC

1111 E. 71st Avenue
Denver, CO 80229

888.286.3931